



Allen-Bradley Bulletin 1325 Encoder Kit

(Cat. No. 1325-E845H-1024-FL)

Instructions

Introduction

This publication is designed to aid in the installation of an Allen-Bradley Encoder Kit on a DC Motor.

The components supplied in the kit include:

- (1) Allen-Bradley 845H Incremental Encoder – 1024PPR with Mating Connector
- (1) Adapter Housing
- (1) Coupling, 0.375" (9.5 mm)
- (2) Hex Cap Plug, 1/2 - 14 NPT
- (4) Bolt, 1/2 - 13 x 1.25
- (4) Lockwashers
- (3) Encoder Mounting Cleats
- (1) Allen Wrench, Motor Mount
- (1) Allen Wrench, Coupling
- (1) Allen Wrench, Hex Cap Plug
- (1) Locking Compound

Additional tools required for installation:

Small Blade Screwdriver

Pre-Installation

Prior to installing the encoder, the motor commutator end shield (opposite the drive end) must be a machined surface with a "C" face having a 7.250" (184.15 mm) diameter bolt circle. The commutator end shield may already be machined to these dimensions, if it is not, the end shield will need to be machined. In addition, the motor stub shaft (user supplied) must have the correct dimensions to accept the coupling. See Figure 1.

Installation

The following procedure assumes that the stub shaft is already installed on the commutator end of the motor shaft. Refer to Figure 2 when performing the following procedure.

Allen-Bradley Parts

1. Mount the non-insulated end of the Coupling to the stub shaft. Allow approximately 0.125" (3.2 mm) gap between the stub shaft base and the barrel of the coupling. The coupling set screws must be oriented to line up with the access holes in the Adaptor Housing. This will allow for subsequent tightening to the encoder shaft. Using the supplied allen wrench, tighten the coupling set screws, connecting the coupling to the motor stub shaft.



CAUTION: To permit easy loosening of the coupling set screws, and guard against possible damage to the screws or coupling, Do Not use locking compound.

-
2. Mount the Adaptor Housing to the motor using the four Bolts, Lockwashers and Locking Compound supplied. Tighten the bolts securely.
 3. Using locking compound, install the three Encoder Mounting Cleats to the encoder mounting surface of the adaptor housing. Ensure that these cleats are located in holes that are 120 degrees apart.
 4. Insert the encoder shaft into the coupling. Position the Encoder on the adaptor housing and rotate the mounting cleats into the groove on the encoder.



CAUTION: To guard against compressing or distorting the coupling, Do Not force the encoder into place.

-
5. When the encoder is properly positioned, tighten the coupling set screws (using the adaptor housing access holes), connecting the coupling to the encoder shaft.
 6. Securely tighten the three encoder mounting cleat screws making sure the rounded end is inserted into the encoder mounting groove.
 7. Seal the adaptor housing access screws with the supplied Hex Cap Plugs, locking compound and allen wrench.

Figure 1
Adapter Housing and Stub Shaft Dimensions

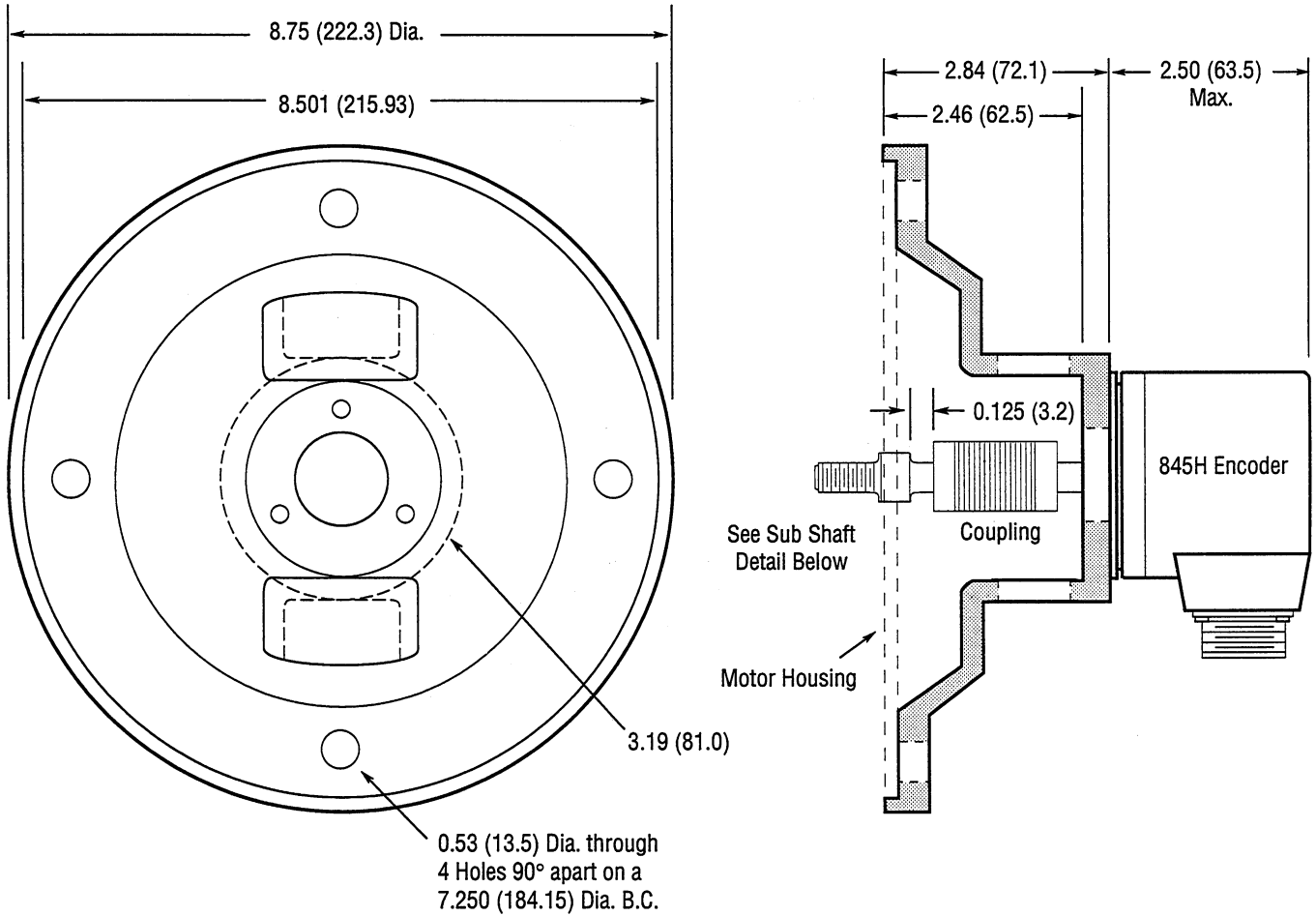

Dimensions are in inches and (millimeters)

Instructions
Encoder Mounting Kit

Figure 2
Encoder Mounting

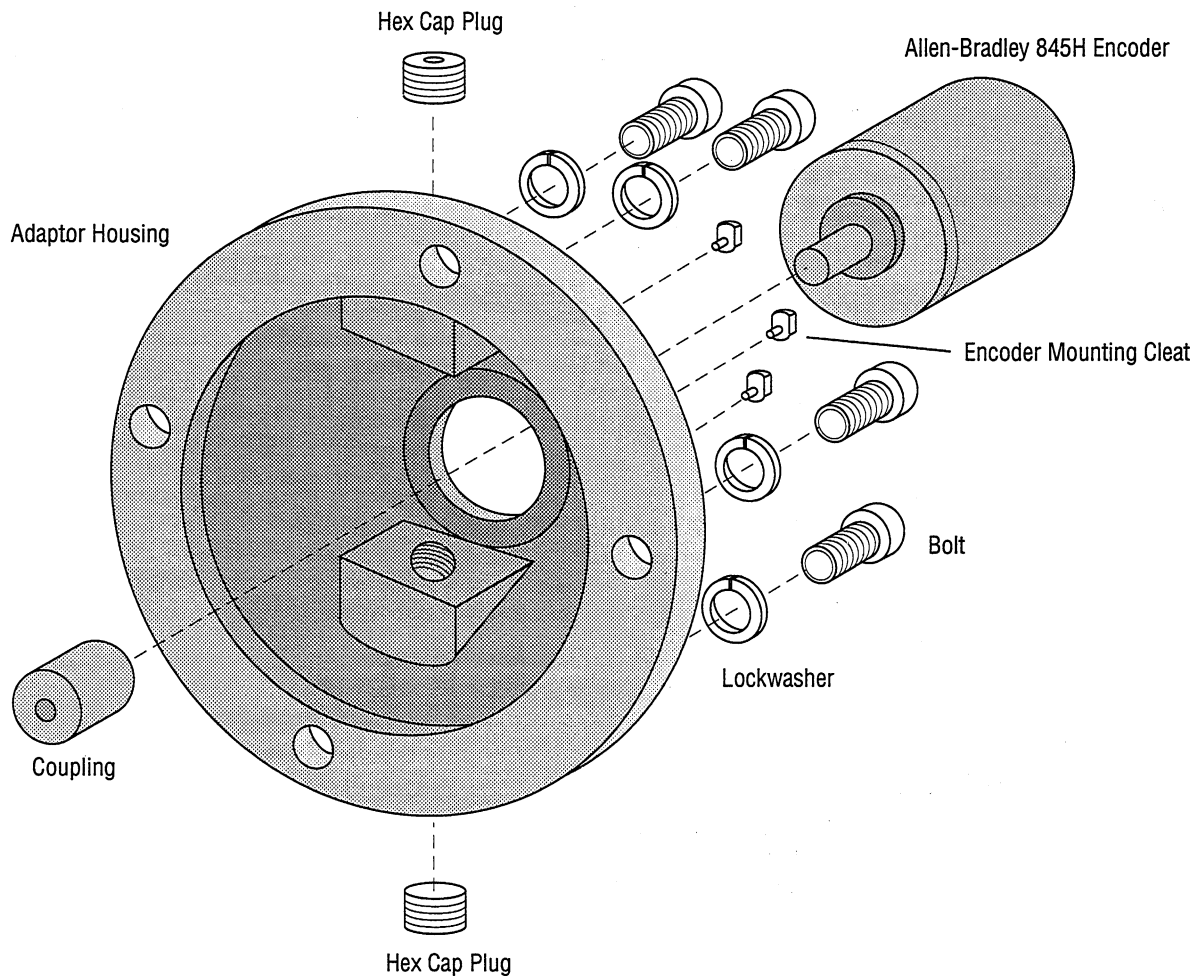

A subsidiary of Rockwell International, one of the world's largest technology companies, Allen-Bradley meets today's automation challenges with over 85 years of practical plant floor experience. More than 12,000 employees throughout the world design, manufacture and apply a wide range of control and automation products and supporting services to help our customers continuously improve quality, productivity and time to market. These products and services not only control individual machines, but also integrate the manufacturing process while providing access to vital plant floor data that can be used to support decision-making throughout the enterprise.

With offices in major cities worldwide.

WORLD HEADQUARTERS
Allen-Bradley
1201 South Second Street
Milwaukee, WI 53204 USA
Tel: (1) 414 382-2000
Telex: 43 11 016
Fax: (1) 414 382-4444

**EUROPE/MIDDLE EAST/
AFRICA HEADQUARTERS**
Allen-Bradley Europe B.V.
Amsterdamsseweg 15
1422 AC Uithoorn
The Netherlands
Tel: (31) 2975/43500
Telex: (844) 18042
Fax: (31) 2975/60222

ASIA/PACIFIC HEADQUARTERS
Allen-Bradley (Hong Kong) Limited
Room 1006, Block B, Sea View Estate
2-8 Watson Road
Hong Kong
Tel: (852) 887-4788
Telex: (780) 64347
Fax: (852) 510-9436

CANADA HEADQUARTERS
Allen-Bradley Canada Limited
135 Dundas Street
Cambridge, Ontario N1R 5X1
Canada
Tel: (1) 519 623-1810
Fax: (1) 519 623-8930

**LATIN AMERICA
HEADQUARTERS**
Allen-Bradley
1201 South Second Street
Milwaukee, WI 53204 USA
Tel: (1) 414 382-2000
Telex: 43 11 016
Fax: (1) 414 382-2400