



1326AB Absolute Encoder Feedback Mounting Adapter Kit

(Catalog No. 1326AB-MOD-Mx2)

Introduction

This publication will guide you through the installation of Bulletin 842A-31-xx absolute encoders to 1326AB servo motors.

Use the information in the following table to verify that you have received the correct kit for your motor.

This adapter kit:	Couples 842A encoders to this servo motor:
1326AB-MOD-M42	1326AB-B4xxxx
1326AB-MOD-M52	1326AB-B5xxxx
1326AB-MOD-M72	1326AB-B7xxxx

What This Kit Contains

Verify that your mounting adapter kit contains the items listed in the following table. If your kit does not contain the correct items, contact your Allen-Bradley sales representative.

Quantity:	Description:
1	Encoder adapter
1	Coupling
1	Gasket, endbell
2	Inspection plug
3-6 ¹	Adapter screws
3	Encoder screws
1	7/64 Allen wrench
1	Coupling instruction sheet

¹ Number of adapter screws vary with size of motor.

Installing the Encoder Feedback Mounting Adapter Kit

Important: This adapter is designed to accept Allen-Bradley 842A encoders only.



ATTENTION: To avoid a shock hazard, ensure that all power to the motor is removed before installing the adapter.

To install the encoder feedback mounting adapter kit:

1. Remove the back plate and gasket from the end of the motor (discard the old gasket). Refer to Figure 3 for an overview of the installation.
2. Thoroughly clean the shafts, coupling bores, and mounting faces to remove oil or any other substance that may be present.
3. Using the allen wrench supplied in the kit, attach the flexible coupling to the stub shaft of the motor (refer to Figure 1 below). When tightening, use no more than 1.8-2.0 N-m (16-18 lb-in.) of torque. The shaft must be visible through the spacings in the coupling.

Important: The flexible coupling contains an insulating sleeve on one end. The sleeve guards against motor generated heat migrating to the encoder. The coupling end with the insulating sleeve must be positioned towards the encoder.

Figure 1
Attaching the Coupling to Motor Shaft

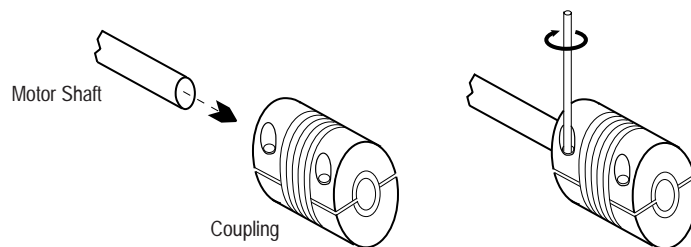

Important: The coupling is a flexible type that must be installed in a relaxed state (not compressed or stretched). Installation in the compressed state will limit the ability of the coupling to flex adequately. Installation in a stretched condition might exceed the couplings yield point when flexed. Either condition will shorten the life of the coupling.

4. Attach the encoder to the adapter using the screws supplied. Tighten the screws using no more than 2.3-2.8 N-m (20-25 lb-in.) of torque.

5. Apply the new endbell gasket on the adapter, position the adapter assembly onto the back of the motor, and insert the encoder shaft into the coupling.
6. Attach the adapter to the motor using the screws supplied. Tighten the screws using no more than 2.3-2.8 N-m (20-25 lb-in.) of torque.
7. Remove the inspection plugs on the side of the adapter to gain access to the coupling.
8. Rotate the coupling in relation to the unfastened shaft, allowing the coupling to seek a normal resting position.

Figure 2
Bringing the Coupling to its Normal Resting Position

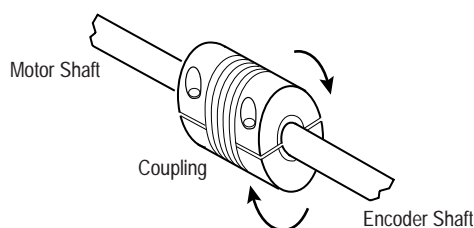

9. Tighten the coupling onto the encoder shaft. When tightening, use no more than 1.8-2.0 N-m (16-18 lb-in.) of torque. The shaft must be visible through the spacings in the coupling.
10. Replace the inspection plugs.
Important: Ensure that the coupling is not compressed or stretched after it has reached its normal resting position.
11. Check for proper operation.

Figure 3
Encoder Feedback Mounting Adapter Overview

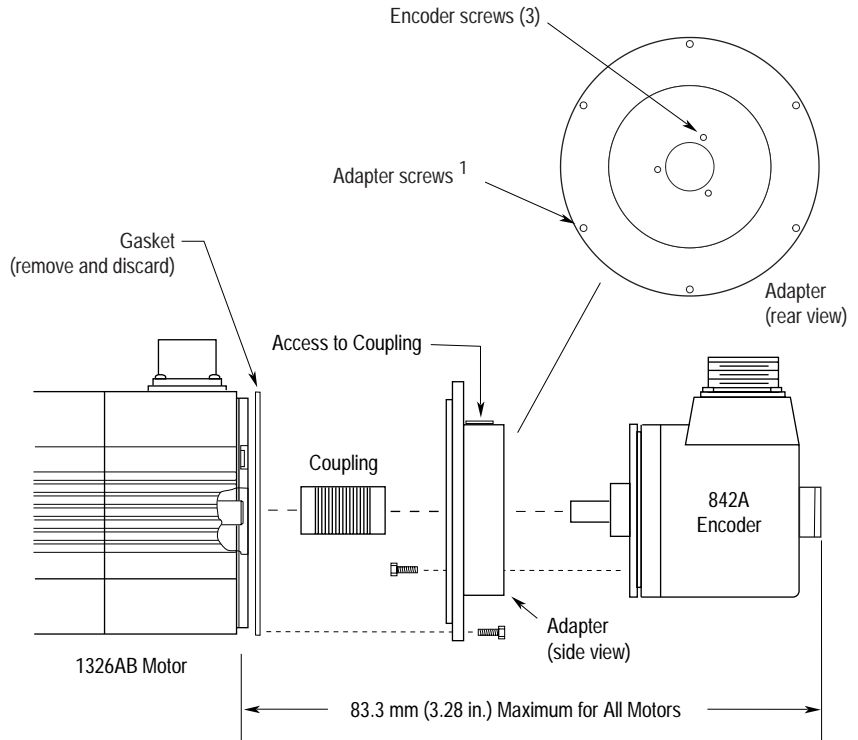

¹ Number of screws will vary with size of motor.

For more information refer to our web site: www.ab.com/motion

Reach us now at www.rockwellautomation.com

Wherever you need us, Rockwell Automation brings together leading brands in industrial automation including Allen-Bradley controls, Reliance Electric power transmission products, Dodge mechanical power transmission components, and Rockwell Software. Rockwell Automation's unique, flexible approach to helping customers achieve a competitive advantage is supported by thousands of authorized partners, distributors and system integrators around the world.

Americas Headquarters, 1201 South Second Street, Milwaukee, WI 53204, USA, Tel: (1)414 382-2000, Fax: (1) 414 382-4444
European Headquarters SA/NV, avenue Herrmann Debroux, 46, 1160 Brussels, Belgium, Tel: (32) 2 663 06 00, Fax: (32) 2 663 06 40
Asia Pacific Headquarters, 27/F Citicorp Centre, 18 Whitfield Road, Causeway Bay, Hong Kong, Tel: (852) 2887 4788, Fax: (852) 2508 1846

