



1326AB Encoder Feedback Mounting Adapter Kit (Cat. No. 1326AB-MOD-Mxx)

Instructions

Introduction

This publication will guide you through installation of the 1326AB Encoder Mounting Adapter to a 1326AB Servomotor.

Using the information below, verify that you have received the correct kit for the motor being used.

<u>Adapter Kit No.</u>	<u>Use to couple an 845H Encoder to . . .</u>
1326AB-MOD-M40 *	1326AB-B4xxx-21, -A4xxx-21 and -Axx-xx Series Motor
1326AB-MOD-M50 *	1326AB-B5xxx-21, -A5xxx-21 and -Bxx-xx Series Motor
1326AB-MOD-M60 *	1326AB-B7xxx-21, -A7xxx-21 and -Cxx-xx Series Motor

* 1326-MOD-Mxx replaces the 1326AB-MOD-Mxx-C1 and 1326AB-MOD-Mxx-C3, however will accept the 845H encoder only.

The components contained in each kit include:

- (1) Encoder Mounting Adapter w/Servo Clamps
- (1) Flexible Coupling
- (1) Allen Wrench, Coupling
- (3) Mounting Screws, Adapter

The following items may be required for installation.

0.375-18 Pip Head Driver
Standard Screwdriver
#10-32 Hex Head Driver
Run-Out Indicator

Installation

Important: This adapter is designed to accept Allen-Bradley 845H encoders Only.



WARNING: If the motor is currently wired into a system, assure that all power to the motor has been removed before installing the adapter to avoid a shock hazard.

Instructions

1326A Encoder Feedback Mounting Adapter

- o 1. Remove the backplate from the end of the motor.
- o 2. Thoroughly clean the shafts, coupling bores and mounting faces to remove oil or any other substance that may be present.
- o 3. **Important:** The supplied flexible coupling contains an insulating sleeve on one end. The sleeve guards against motor generated heat migrating to the encoder. The coupling end with the insulating sleeve must be positioned towards the encoder.

Using the supplied allen wrench, attach the flexible coupling to the stub shaft of the motor. When tightening, use no more than 1.8-2.0 N-m (16-18 lb.-in.) of torque. The shaft must be visible through the spacings in the coupling.

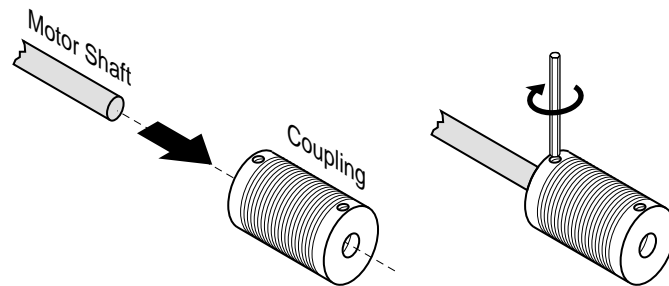

Important: The coupling is a flexible type which must be installed in a relaxed state (not compressed or stretched). Installation in the compressed state will limit the ability of the coupling to flex adequately. Installation in a stretched condition may exceed the couplings yield point when flexed. Either condition will shorten the life of the coupling.

- o 4. Attach the adapter to the motor using the supplied screws. Tighten the screws using no more than 2.3-2.8 N-m (20-25 lb.-in.) of torque
- o 5. Insert the encoder shaft into the coupling. Position the encoder on the adapter and rotate the servo clamps into the groove on the encoder.
- o 6. Tighten the servo clamps.
- o 7. Remove the inspection plug on the side of the adapter to gain access to the coupling. Rotate the coupling in relation to the unfastened shaft, allowing the coupling to seek a normal resting position.

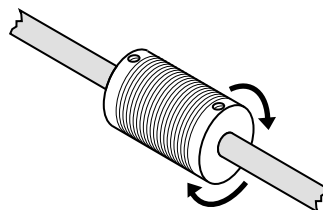

Instructions

1326A Encoder Feedback Mounting Adapter

- o 8. Tighten the coupling onto the encoder shaft. Replace inspection plug.
Important: Assure that the coupling is not compressed or stretched after it has reached its normal aligned position.
- o 9. Check for proper operation.

