

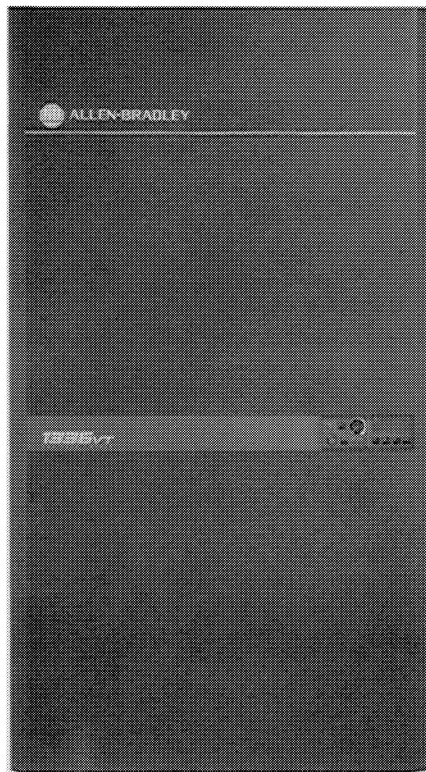

# **Allen-Bradley 1336VT 96-180 Amp NEMA Type 1 Enclosure**

Cat. No. 1336VT-MOD-EAT

## Installation Data



### **What These Instructions Contain**

These instructions provide the necessary information to enclose a 96-180 Amp open style 1336VT drive.

### **Where This Kit is Used**

#### **1336VT Drives**

B075	B125
B100	B150

### **Who These Instructions are For**

These instructions are intended to be used by qualified personnel familiar with the functions of solid state drive equipment. Personnel must read and understand the following instructions as well as the Hardware User Manual before attempting to install an open style 1336VT drive.

## What This Kit Includes

As shown on the opposite page, each 1336VT-MOD-EAT kit includes:

- ❶ — (1) Top Panel, P/N 142203
- ❷ — (1) Bottom Panel, P/N142204
- ❸ — (1) Left Side Panel, P/N 142202
- ❹ — (1) Right Side Panel, P/N 142205
- ❺ — (1) Communications Port Cover, P/N 145112
- ❻ — (1) Front Cover, P/N 142206
- ❼ — (30) 8-32 × 3/8 Inch Phillips Screws, P/N 109842
- ❽ — (4) 6-32 × 3/8 Inch Phillips Screws, P/N 109844

To assemble the kit, access to the top, bottom and both sides of the drive chassis is required.

If the open chassis drive is already installed, remove power to the drive. Mark and disconnect all control and power wiring. Control and power wiring must be rerouted through the top panel knockouts once the kit has been installed.

## Installation



**WARNING:** Electric shock can cause injury or death. Remove all power before working on this product.

---

Installation involves using twenty-eight of the 8-32 screws to secure the top panel, bottom panel and two side panels to the drive chassis. If the 1336-MOD-S1 Serial Port Connector is not installed, the remaining two screws are used to secure the communications port cover. If the 1336-MOD-S1 Serial Port Connector is installed, the communications port cover may be discarded. The two captive thumb screws at the bottom of the enclosure and the four 6-32 screws ❽ are used to secure the cover to the enclosure.

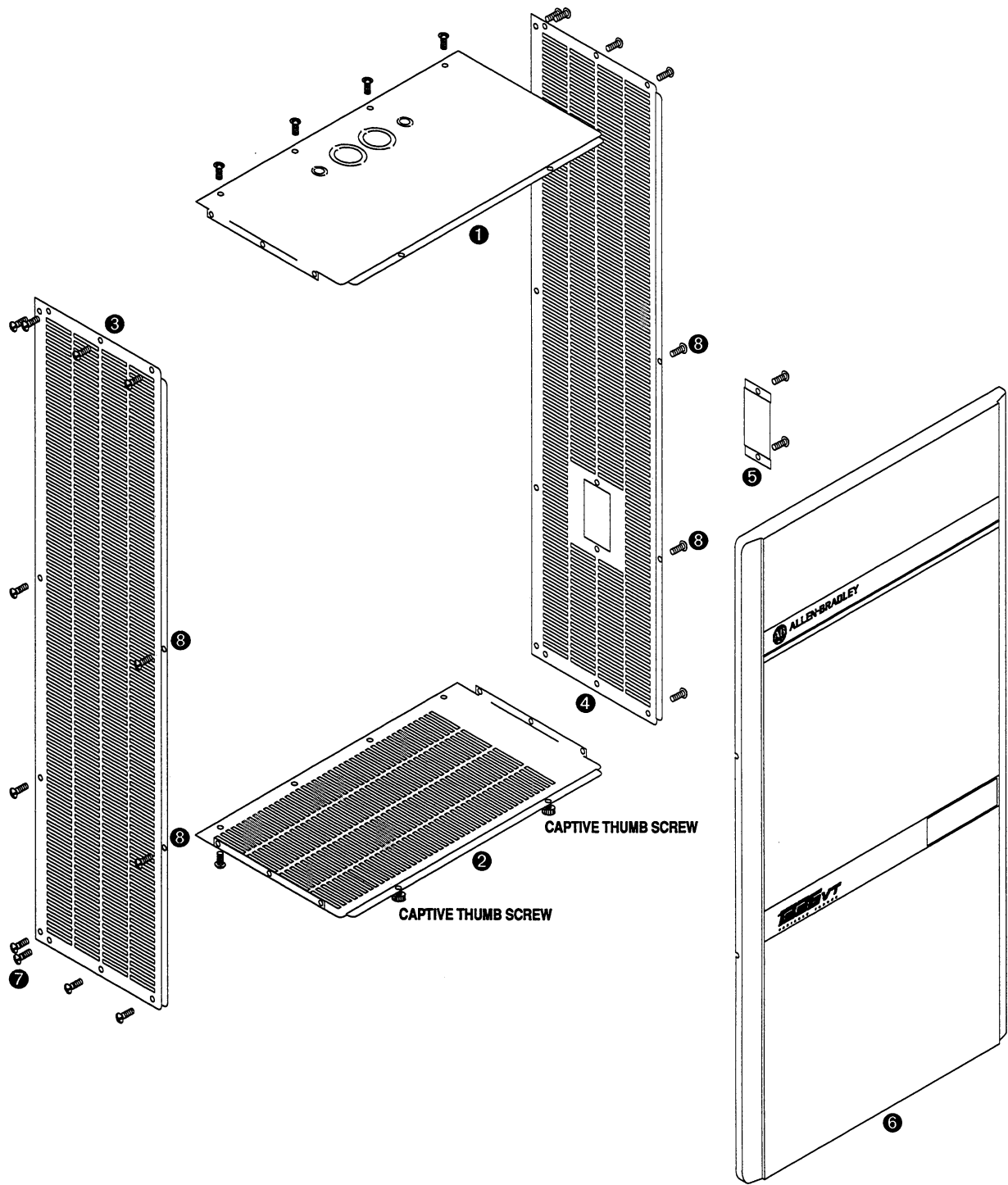



**ALLEN-BRADLEY**  
A ROCKWELL INTERNATIONAL COMPANY

A subsidiary of Rockwell International, one of the world's largest technology companies, Allen-Bradley meets today's automation challenges with over 85 years of practical plant floor experience. More than 12,000 employees throughout the world design, manufacture and apply a wide range of control and automation products and supporting services to help our customers continuously improve quality, productivity and time to market. These products and services not only control individual machines, but also integrate the manufacturing process while providing access to vital plant floor data that can be used to support decision-making throughout the enterprise.

With offices in major cities worldwide.

**WORLD HEADQUARTERS**

Allen-Bradley  
1201 South Second Street  
Milwaukee, WI 53204 USA  
Tel: (1) 414 382-2000  
Telex: 43 11 016  
Fax: (1) 414 382-4444

**EUROPE/MIDDLE EAST/  
AFRICA HEADQUARTERS**

Allen-Bradley Europe B.V.  
Amsterdamseweg 15  
1422 AC Uithoorn  
The Netherlands  
Tel: (31) 2975/43500  
Telex: (844) 18042  
Fax: (31) 2975/60222

**ASIA/PACIFIC HEADQUARTERS**

Allen-Bradley (Hong Kong) Limited  
Room 1006, Block B, Sea View Estate  
2-8 Watson Road  
Hong Kong  
Tel: (852) 887-4788  
Telex: (780) 64347  
Fax: (852) 510-9436

**CANADA HEADQUARTERS**

Allen-Bradley Canada Limited  
135 Dundas Street  
Cambridge, Ontario N1R 5X1  
Canada  
Tel: (1) 519 623-1810  
Fax: (1) 519 623-8930

**LATIN AMERICA  
HEADQUARTERS**

Allen-Bradley  
1201 South Second Street  
Milwaukee, WI 53204 USA  
Tel: (1) 414 382-2000  
Telex: 43 11 016  
Fax: (1) 414 382-2400