



1394 Shunt Module for the 22 kW Smart System

(Catalog Number 1394-SRxAx)

The 1394-SRxAx shunt module must be used with the 1394 22 kW Smart System. Use this Information Sheet with the *1394 Digital AC Multi-Axis Motion Control System User Manual* (publication 1394-5.0). Use the following table to locate the shunt module catalog numbers and ratings.

Important: Follow the minimum spacing requirements as shown in the *1394 Digital AC Multi-Axis Motion Control System User Manual* (publication 1394-5.0).

Catalog Number	Ratings	Shipping Weight	Resistance	Agency Certifications
1394-SR9A	300 W continuous, 160,000 W peak, module	3.63 kg (8 lb)	4 Ohms	For all applicable directives: <ul style="list-style-type: none"> • UL Listed (file #E59272) • CUL Listed • CE marked
1394-SR9AF	900 W continuous, 160,000 W peak, module	4.08 kg (9 lb)		
1394-SR36A	1800 W Continuous, 160,000 W peak, module	8.6 kg (19.0 lb)		
1394-SR36AF	3600 W continuous, 160,000 W peak, fan-cooled module	9.0 kg (20.0 lb)		

Figure 1
22 kW Shunt Modules

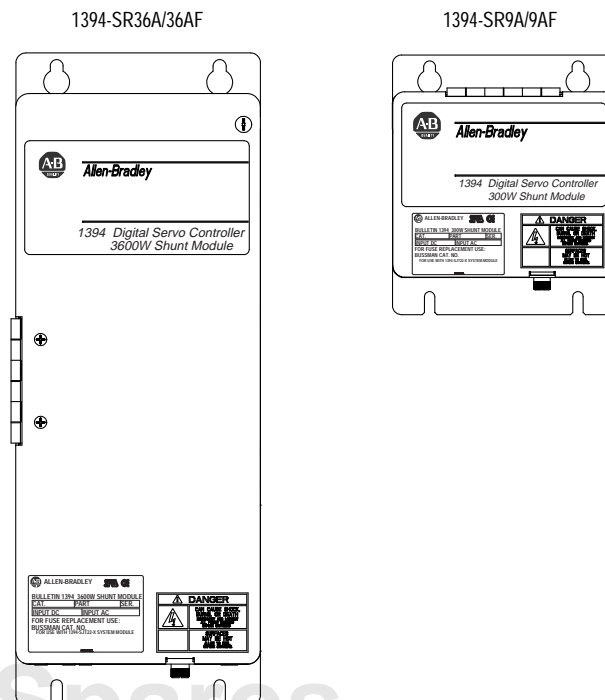

AB Spares

For more information refer to our web site: www.ab.com/motion

Reach us now at www.rockwellautomation.com

Wherever you need us, Rockwell Automation brings together leading brands in industrial automation including Allen-Bradley controls, Reliance Electric power transmission products, Dodge mechanical power transmission components, and Rockwell Software. Rockwell Automation's unique, flexible approach to helping customers achieve a competitive advantage is supported by thousands of authorized partners, distributors and system integrators around the world.

Americas Headquarters, 1201 South Second Street, Milwaukee, WI 53204, USA, Tel: (1) 414 382-2000, Fax: (1) 414 382-4444
European Headquarters SA/NV, avenue Herrmann Debroux, 46, 1160 Brussels, Belgium, Tel: (32) 2 663 06 00, Fax: (32) 2 663 06 40
Asia Pacific Headquarters, 27/F Citicorp Centre, 18 Whitfield Road, Causeway Bay, Hong Kong, Tel: (852) 2887 4788, Fax: (852) 2508 1846



**Rockwell
Automation**