

## DIN Rail Adaptor Kit

### Attaching Adapters

1. Remove old screws from the corners of the rear panel.
2. Attach adapters to rear panel using the screws included with the adapter.



### DIN Rail Mounting

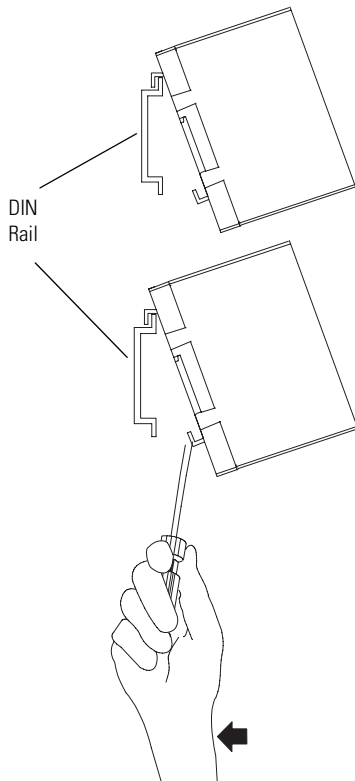

#### *Install*

1. Mount your DIN rail.
2. Hook the top of the adapter over the DIN rail
3. While pressing the unit against the rail, snap the unit into position.

#### *Removal*

1. Place a screwdriver under the adapter at the bottom of the unit.
2. Pry the adapter away from the DIN rail until the unit is released from the DIN rail. Complete this for both sides of the unit.
3. Lift unit away from DIN rail.

# IP65 Protective Cover

Fit the protective cover over the front of the MiniPowermonitor. Make sure that the cover fits over each corner.



[www.rockwellautomation.com](http://www.rockwellautomation.com)

---

## Power, Control and Information Solutions Headquarters

Americas: Rockwell Automation, 1201 South Second Street, Milwaukee, WI 53204-2496 USA, Tel: (1) 414.382.2000, Fax: (1) 414.382.4444

Europe/Middle East/Africa: Rockwell Automation, Vorstlaan/Boulevard du Souverain 36, 1170 Brussels, Belgium, Tel: (32) 2 663 0600, Fax: (32) 2 663 0640

Asia Pacific: Rockwell Automation, Level 14, Core F, Cyberport 3, 100 Cyberport Road, Hong Kong, Tel: (852) 2887 4788, Fax: (852) 2508 1846

Publication 1405-IN003A-EN-P - April 2004

PN 40055-224-01(1)

Copyright © 2004 Rockwell Automation, Inc. All rights reserved. Printed in the U.S.A.