

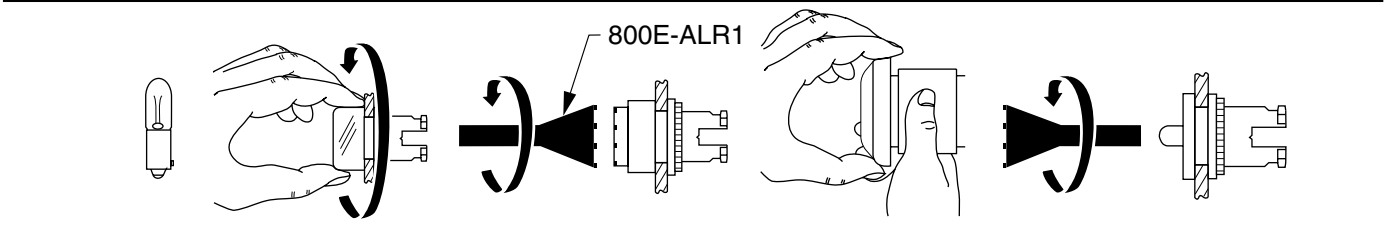

Allen-Bradley

IEC: IP66									
FOR USE ON A FLAT SURFACE OF A TYPE 4 OR 13 ENCLOSURE									
						Ø40, Ø60		 Ø60, Ø90	
		30 (13/16)		48 (157/64)		40/60 (137/64-23/8)			
		40 (137/64)	50 (131/32)	40 (137/64)	50 (131/32)	40/60 (137/64-23/8)	50/60 (131/32-23/8)	60/90 (23/8-335/64)	
		50 (131/32)				50/60 (131/32-23/8)			

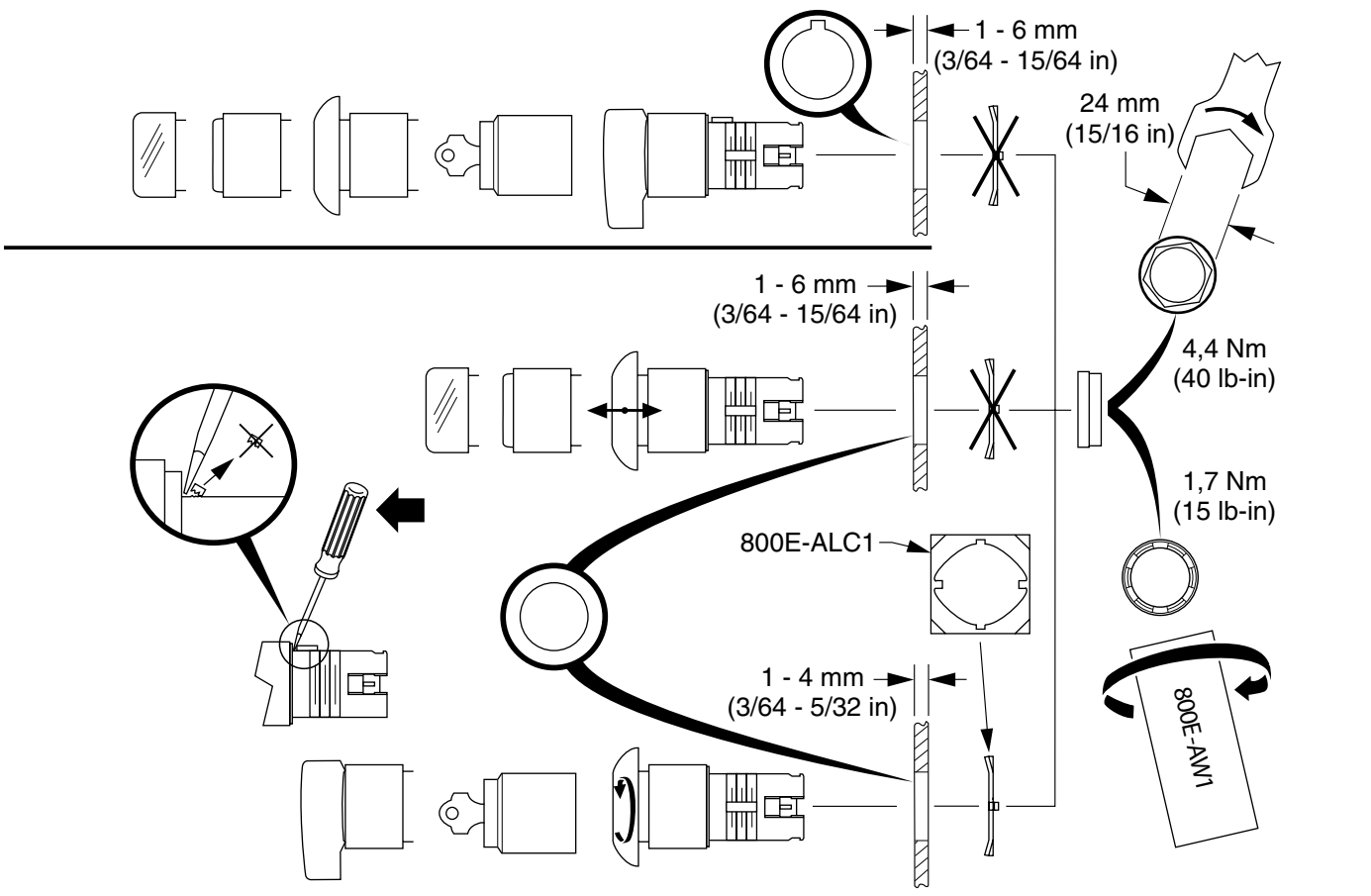

Allen-Bradley PLCs



Allen-Bradley

