

- NOTE: (1) DIMENSIONS ARE NOT FOR MANUFACTURING PURPOSES.
 (2) DIMENSION SHOWN APPLIES TO 2SF THROUGH 4SF UNITS ONLY.
 (3) DIMENSION SHOWN APPLIES TO 1SF AND 1.5SF UNITS
 (4) TERMINAL BLOCK MOUNTING TABS ARE ONLY SUPPLIED WHEN OPTIONS -800 TO -805 ARE SPECIFIED. TABS ACCOMMODATE PART NUMBER 1492-EC85 (5 POLE) AND 1492-ED103 (3 POLE) TERMINAL BLOCKS.

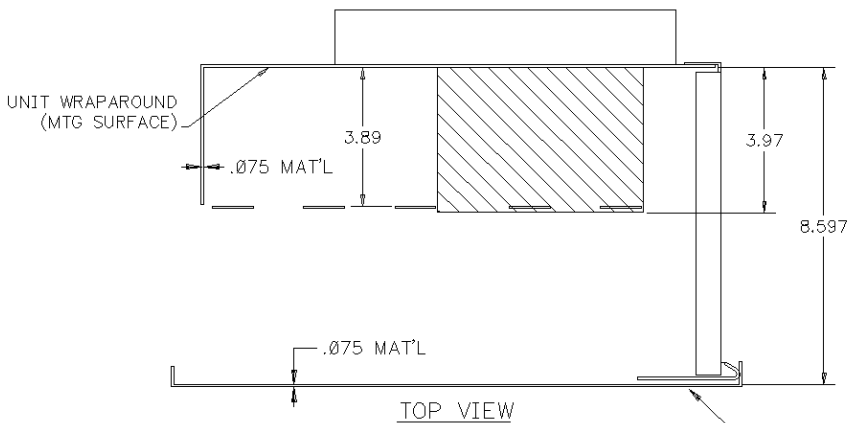

TOP VIEW

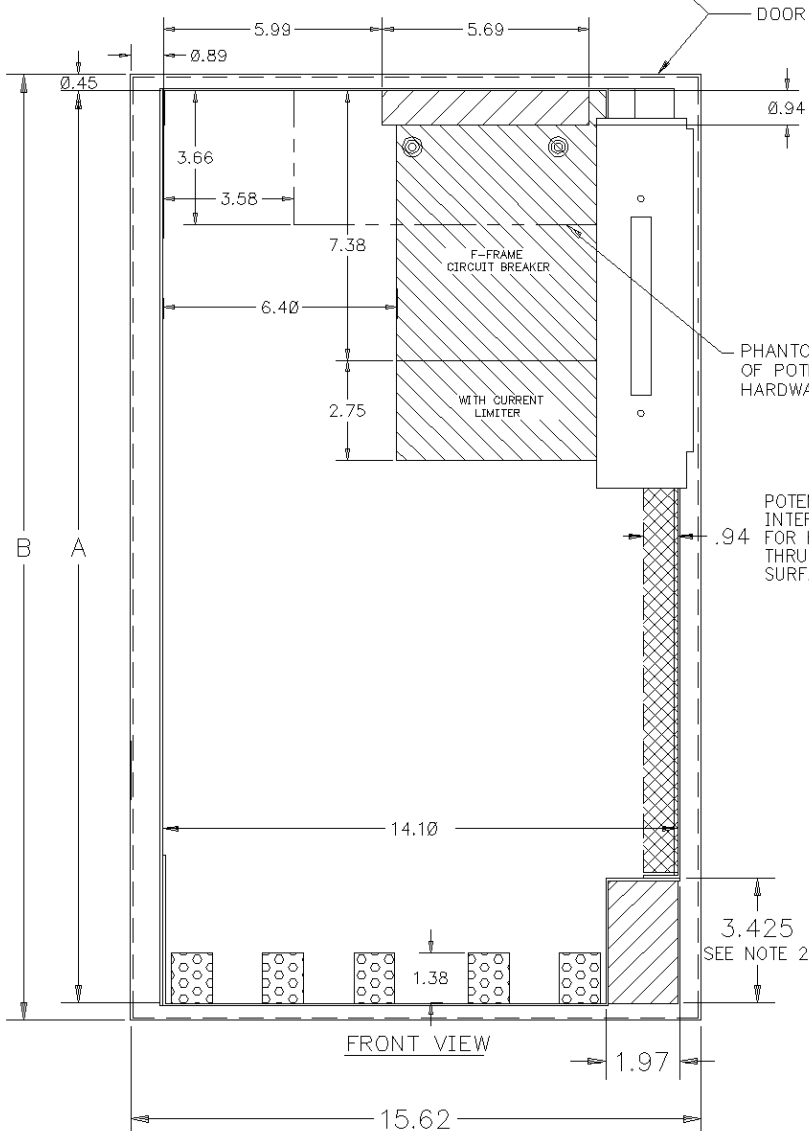

FRONT VIEW

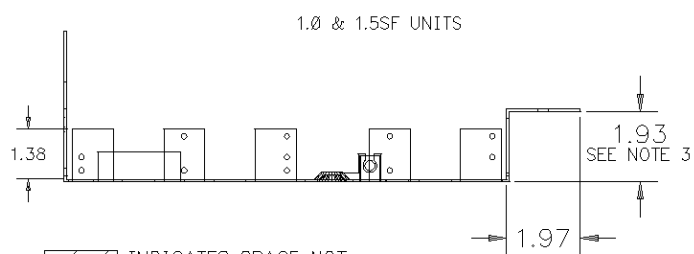

1.0 & 1.5SF UNITS

- INDICATES SPACE NOT AVAILABLE AS MOUNTING SURFACES.
- INDICATES POTENTIAL INTERFERENCE FOR HARDWARE THRU MOUNTING SURFACE.
- INDICATES POTENTIAL INTERFERENCE FROM TABS FORWARD OF MOUNTING SURFACE.
- INDICATES SPACE REQUIRED FOR CIRCUIT BREAKER

PARTS MUST CONFORM TO APPLICABLE ALLEN-BRADLEY CO. WORKMANSHIP STANDARD 40126-700

2100M UNIT INSERT W/F-FRAME CIRCUIT BREAKER (SEE NOTE 4)	4	51.12	51.906
	3.5	44.62	45.406
	3	38.12	38.906
	2.5	31.62	32.406
	2	25.12	25.906
	1.5	18.62	19.406
SPACE FACTOR	DIM A	DIM B	

References		Dimensions Apply Before Surface Treatment
Revision	Release	
1	15667-05	Dimensions in Inches Tolerances Unless Otherwise Specified
2	10664-06	2 Place Decimal ±.02
		3 Place Decimal ±.005
		Angles ±1°

DIMENSION DRAWING	
FOR 2100M UNIT INSERT	
W/F FRAME CIRCUIT BREAKER	
(150AMP MAX.)	
Dr. S. Tietyen	Date 11-30-2005
Chkd. JIM KELLY	Date 2-22-06
Appd. T. SAUVE	Date 2-22-06

THIS PART	REV. LTR.
-01	2
<small>CONFIDENTIAL AND PROPRIETARY INFORMATION. THIS DOCUMENT CONTAINS CONFIDENTIAL AND PROPRIETARY INFORMATION OF ROCKWELL AUTOMATION, INC. AND MAY NOT BE USED, COPIED OR DISCLOSED TO OTHERS EXCEPT WITH THE AUTHORIZED WRITTEN PERMISSION OF ROCKWELL AUTOMATION, INC.</small>	
Sheet	1 Of 1
Dwg Size	C
30101-528	